

HEX NIPPLE

MALE NPT SIZE P	BASIC ORDERING NUMBER	A	MIN OPENING E	HEX FLAT F
1/16	-2-WHN	1.01	.12	5/16
1/8	-2-WHN	1.01	.19	7/16
1/4	-4-WHN	1.40	.28	9/16
3/8	-6-WHN	1.43	.38	11/16
1/2	-8-WHN	1.84	.47	7/8
3/4	-12-WHN	1.84	.62	1-1/16
1	-16-WHN	2.32	.88	1-3/8

HEX REDUCING NIPPLE

MALE NPT SIZE P	MALE NPT SIZE P1	BASIC ORDERING NUMBER	A	MIN OPENING E	HEX FLAT F
1/8	1/16	-2-WHRN-1	1.01	.12	7/16
1/2	1/8	-4-WHRN-2	1.22	.19	9/16
3/8	1/8	-6-WHRN-2	1.25	.19	11/16
3/8	1/4	-6-WHRN-4	1.43	.28	11/16
1/2	1/8	-8-WHRN-2	1.47	.19	7/8
1/2	1/4	-8-WHRN-4	1.65	.28	7/8
1/2	3/8	-8-WHRN-6	1.65	.38	7/8
3/4	1/4	-12-WHRN-4	1.65	.28	1-1/16
3/4	1/2	-12-WHRN-8	1.84	.47	1-1/16
1	1/2	-16-WHRN-8	2.13	.47	1-3/8
1	3/4	-16-WHRN-12	2.13	.62	1-3/8

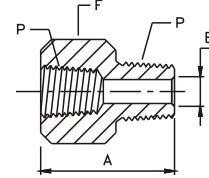
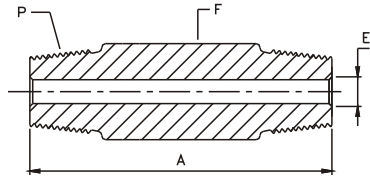

HEX LONG NIPPLE

P MALE NPT SIZE	BASIC ORDERING NUMBER	A AVAILABLE LENGTH					E MIN OPENING	F HEX FLAT
		1.50	2.00	2.50	3.00	4.00		
1/8	-2-WHLN	4	4	4	4	NIA	.19	7/16
1/4	-4-WHLN	4	4	4	4	4	.28	9/16
3/8	-6-WHLN	4	4	4	4	NIA	.38	11/16
1/2	-8-WHLN	NIA	4	NIA	4	4	.47	7/8
3/4	-12-WHLN	NIA	4	NIA	4	4	.62	1-1/16
1	-16-WHLN	NIA	NIA	NIA	4	4	.88	1-3/8

ADAPTOR

MALE & FEMALE NPT SIZE P	BASIC ORDERING NUMBER	A	MIN OPENING E	HEX FLAT F
1/8	-2-WHA	1.10	.19	9/16
1/4	-4-WHA	1.40	.28	3/4
3/8	-6-WHA	1.49	.38	7/8
1/2	-8-WHA	1.94	.47	1-1/16
3/4	-12-WHA	2.00	.62	1-5/6
1	-16-WHA	2.28	.88	1-5/8

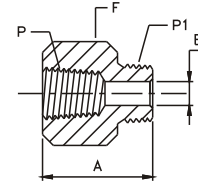
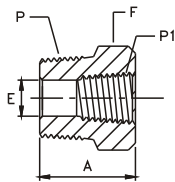

REDUCING BUSHING

MALE NPT SIZE P	MALE NPT SIZE P	BASIC ORDERING NUMBER	A	MIN OPENING E	HEX FLAT H
1/8	1/16	-2-WRB1	1.03	.19	7/16
1/4	1/8	-4-WRB2	1.06	.28	9/16
3/8	1/8	-6-WRB2	.86	.34	11/16
3/8	1/4	-6-WRB4	1.19	.38	3/4
1/2	1/8	-8-WRB2	1.08	.34	7/8
1/2	1/4	-8-WRB4	1.08	.45	7/8
1/2	3/8	-8-WRB6	1.41	.47	7/8
3/4	1/4	-12-WRB4	1.08	.45	1-1/16
3/4	3/8	-12-WRB6	1.08	.59	1-1/16
3/4	1/2	-12-WRB8	1.63	.52	1-1/16
1	1/4	-16-WRB4	1.37	.45	1-3/8
1	3/8	-16-WRB6	1.37	.59	1-3/8
1	1/2	-16-WRB8	1.37	.73	1-3/8
1	3/4	-16-WRB12	1.85	.88	1-3/8

REDUCING ADAPTOR

FEMALE NPT SIZE P	MALE NPT SIZE P1	BASIC ORDERING NUMBER	A	MIN OPENING E	HEX FLAT H
1/8	1/16	-2-WRA-1	1.09	.12	9/16
1/4	1/8	-4-WRA-2	1.26	.19	3/4
3/8	1/8	-6-WRA-2	1.33	.19	7/8
3/8	1/4	-6-WRA-4	1.50	.28	7/8
1/2	1/8	-8-WRA-2	1.58	.19	1-1/16
1/2	1/4	-8-WRA-4	1.76	.28	1-1/16
1/2	3/8	-8-WRA-6	1.75	.38	1-1/16
3/4	1/4	-12-WRA-4	1.82	.28	1-5/16
3/4	3/8	-12-WRA-6	1.82	.38	1-5/16
3/4	1/2	-12-WRA-8	2.02	.47	1-5/16
1	1/4	-16-WRA-4	1.96	.28	1-5/8
1	1/2	-16-WRA-8	2.16	.47	1-5/8
1	3/4	-16-WRA-12	2.17	.62	1-5/8

All dimensions are for reference purpose only & subject to change.